



# POWER SUPPLY MODEL 580000 5-32 VDC

The Model 580000 Power Supply is designed for general-purpose instrumentation applications. This Power Supply has been packaged in a rugged JIC enclosure which makes it ideal for hostile plant environments. Standard features of the 580000 are short circuit protection, all welded steel case and full rated operation to 160° F. All Telmar Power Supplies are subject to 120 burn-in hours prior to final inspection and shipment.

## MODEL 580000 GENERAL PURPOSE POWER SUPPLY

### TECHNICAL SPECIFICATIONS

**INPUT:**

117/220 Volts A.C. 50/60Hz! +-8%

**OUTPUT VOLTAGES:**

5 VDC, 8 VDC, 12 VDC, 15 VDC, 18 VDC  
24 VDC, 28 VDC, 32 VDC

**OUTPUT CURRENT:**

125 MADC (3 Watts)

**ACCURACY:**

+/-0.5% Typical

**LOAD REGULATION:**

0.3% Typical

**OUTPUT RIPPLE:**

Less than 2.0 mv P/P

**AMBIENT TEMPERATURE:**

-10 F to 160 F

**ENCLOSURE:**

16-ga steel, light blue finish

### OPTIONS

NEMA 7/9 Explosion Proof Housing-  
Model 580002

A.C. Line Cord and Test Leads

Open Frame (No Case) Contact  
Factory



Size 4" x 4" x 2 3/4"

### APPLICATIONS AND FEATURES

- Power 5 "Two Wire" Transmitters
- A.C. Line Fuse (Internal)
- 120 hr. Burn-In at 10% Overload
- Integrated Circuit Regulation
- JIC Liquid Resistant Steel Case
- Short Circuit Protected Output
- 1/2" Conduit Openings

Analynk Wireless, LLC ❖ 790 Cross Pointe Road ❖ Columbus, OH 43230  
Phone: (614) 755-5091 ❖ Fax: (614) 755-5093 ❖ Web: [www.analynk.com](http://www.analynk.com)

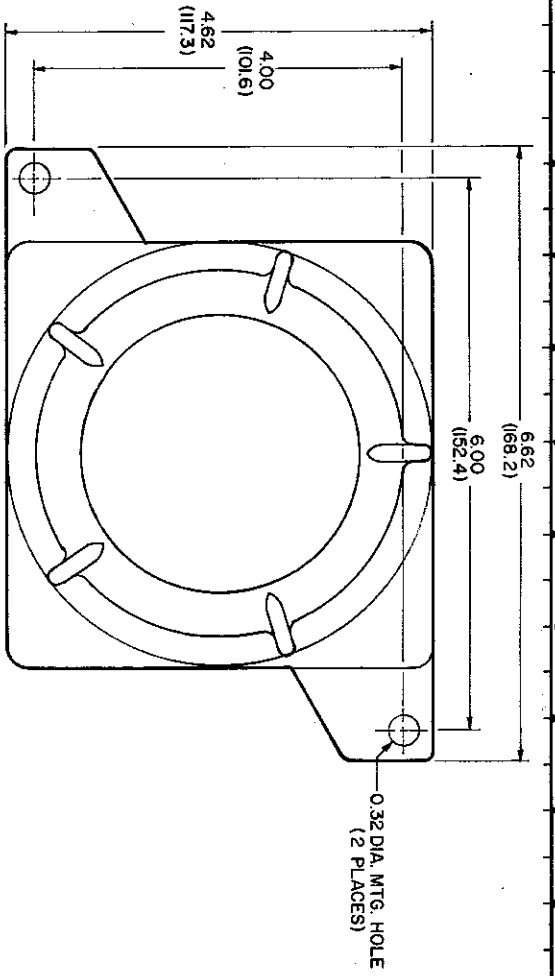

FRONT VIEW

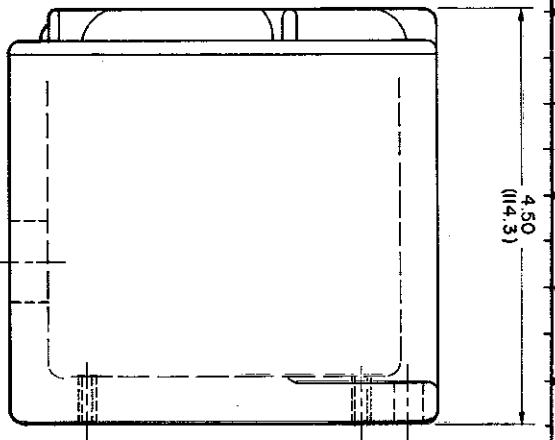

RIGHT SIDE VIEW

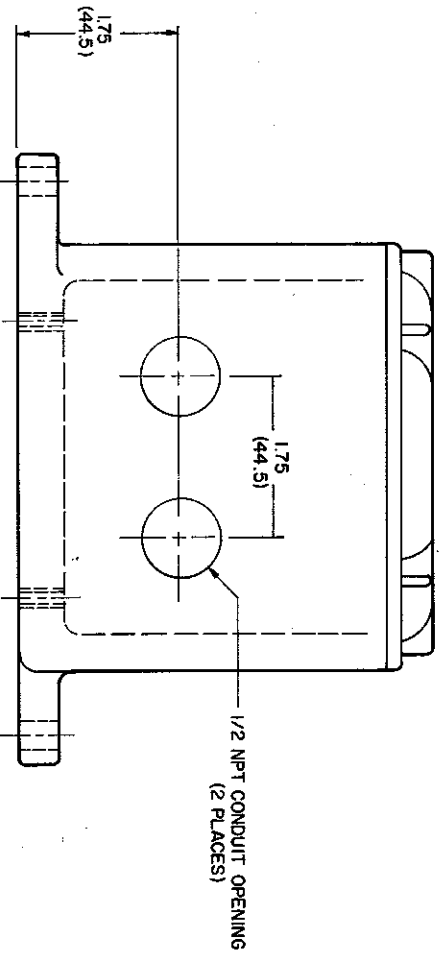

BOTTOM VIEW

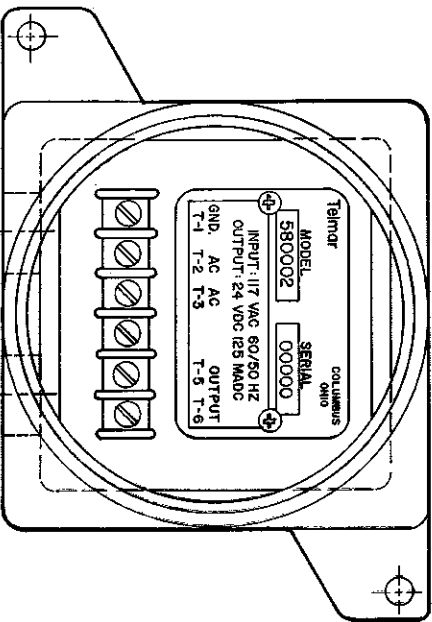

FRONT VIEW  
COVER REMOVED

WIRING CONNECTIONS

- T-1 GROUND (AC)(GND)
- T-2 AC INPUT (H)
- T-3 AC INPUT (N)
- T-4 NOT USED
- T-5 NEGATIVE (-)
- T-6 POSITIVE (+)

3. ALL DIMENSIONS SHOWN IN PARENTHESES ARE IN MILLIMETERS UNLESS OTHERWISE SPECIFIED.
2. WEIGHT INCLUDING INSTRUMENT IS 4.5 LBS. (2.1 KILOGRAMS).
1. NEMA 7CD, 9EFG CAST COPPER FREE K-27 ALUMINUM ALLOY.
- NOTES:

QUAN.	PART NO.	ITEM	DESCRIPTION	ORIG. DWG.	ITEM
			<b>Telmar Inc.</b> COLUMBUS, OHIO		
TITLE 580002 SERIES DC POWER SUPPLY FOR EXPLOSION PROOF					
DRAWN R.A.L. DATE 2/27/94					
CHECKED DATE					
APPROVED DATE					
MACHINE SIZE FIRST USED ON					

DWG. NO.  
**SD-C-0138**

REVISIONS

A	

DWG.  
**C-SD-C-0138**